

ORDINANCE NO. _____

An ordinance amending Section 12.04 of the Los Angeles Municipal Code by amending the zoning map.

THE PEOPLE OF THE CITY OF LOS ANGELES DO ORDAIN AS FOLLOWS:

Section 1. Section 12.04 of the Los Angeles Municipal Code is hereby amended by changing the zone and zone boundaries shown upon a portion of the zone map attached thereto and made a part of Article 2, Chapter 1 of the Los Angeles Municipal Code, so that such portion of the zoning map shall be as follows:

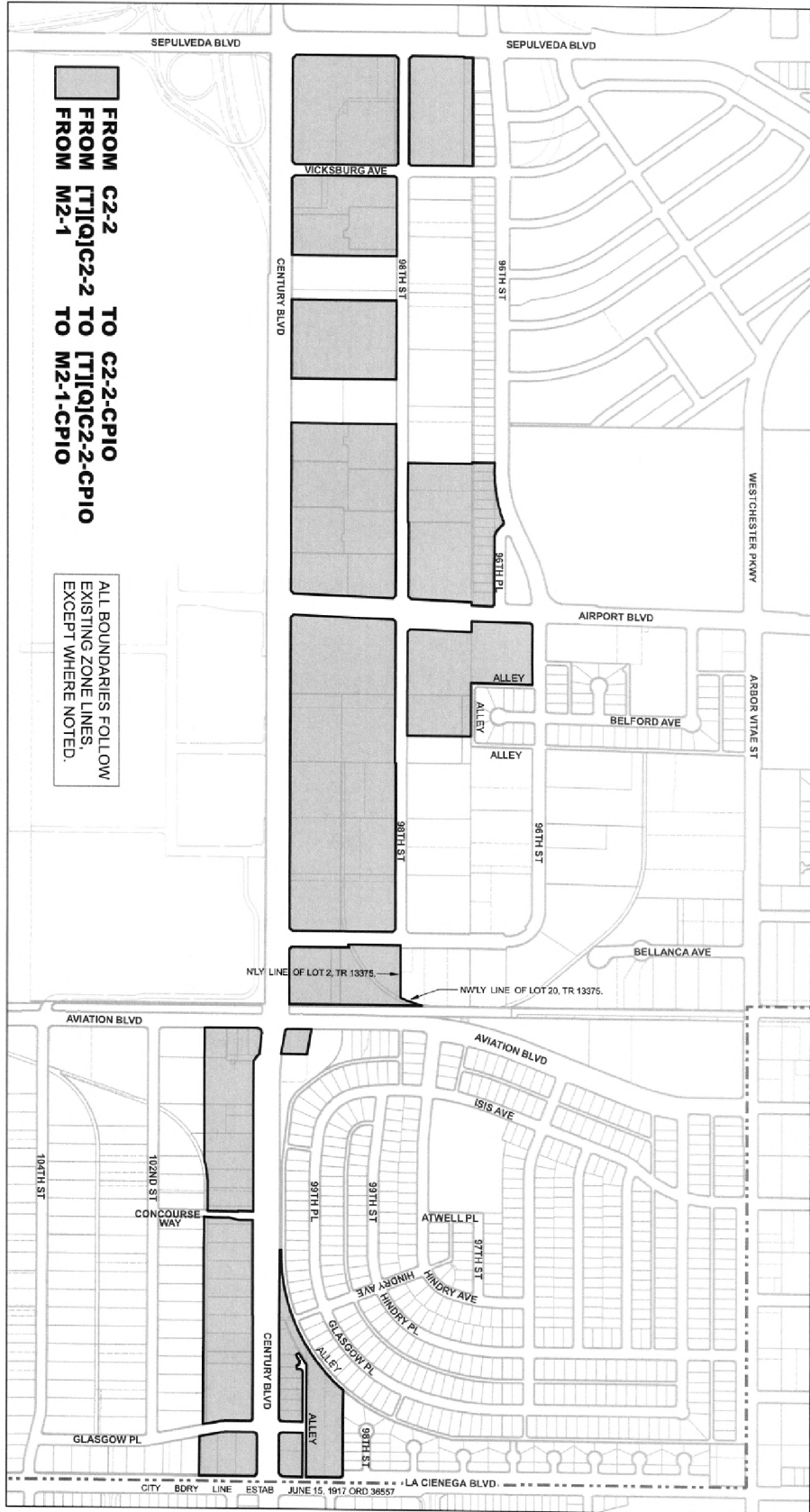

Community Plan Implementation Overlay (CPIO)
Westchester - Playa Del Rey CPIO
Century/Aviation Subarea

500 250 0 500 Feet

ALL BOUNDARIES FOLLOW EXISTING ZONE LINES, EXCEPT WHERE NOTED.

FROM C2-2 TO C2-2-CPIO
 FROM T11QJC2-2 TO T11QJC2-2-CPIO
 FROM M2-1 TO M2-1-CPIO

C.M. 090 B 165, 090 B 169, 090 B 173,
 093 B 165, 093 B 169, 093 B 173.

CPC-2017-4385-ZC

110217

Data Sources: Department of City Planning & Bureau of Engineering



Sec. XX. The City Clerk shall certify to the passage of this ordinance and have it published in accordance with Council policy, either in a daily newspaper circulated in the City of Los Angeles or by posting for ten days in three public places in the City of Los Angeles: one copy on the bulletin board located at the Main Street entrance to the Los Angeles City Hall; one copy on the bulletin board located at the Main Street entrance to the Los Angeles City Hall East; and one copy on the bulletin board located at the Temple Street entrance to the Los Angeles County Hall of Records.

Pursuant to Section 558 of the City Charter, the City Planning Commission on **March 8, 2018** recommends this ordinance **BE ADOPTED** by the City Council.

By  _____
James K. Williams
Commission Executive Assistant II

File No. _____

I hereby certify that the foregoing ordinance was passed by **a vote of not less than two-thirds of all its members** by the Council of the City of Los Angeles.

CITY CLERK

MAYOR

Ordinance Passed _____

Approved _____